

APPROVED

VIDE Lr. No. D2 (C) / 3258/89
 Dtd.....=7-89

o/c

P.P. D No: 152
 L.O. 89

FOR MEMBER SECRETARY
 MADRAS METROPOLITAN
 DEVELOPMENT AUTHORITY

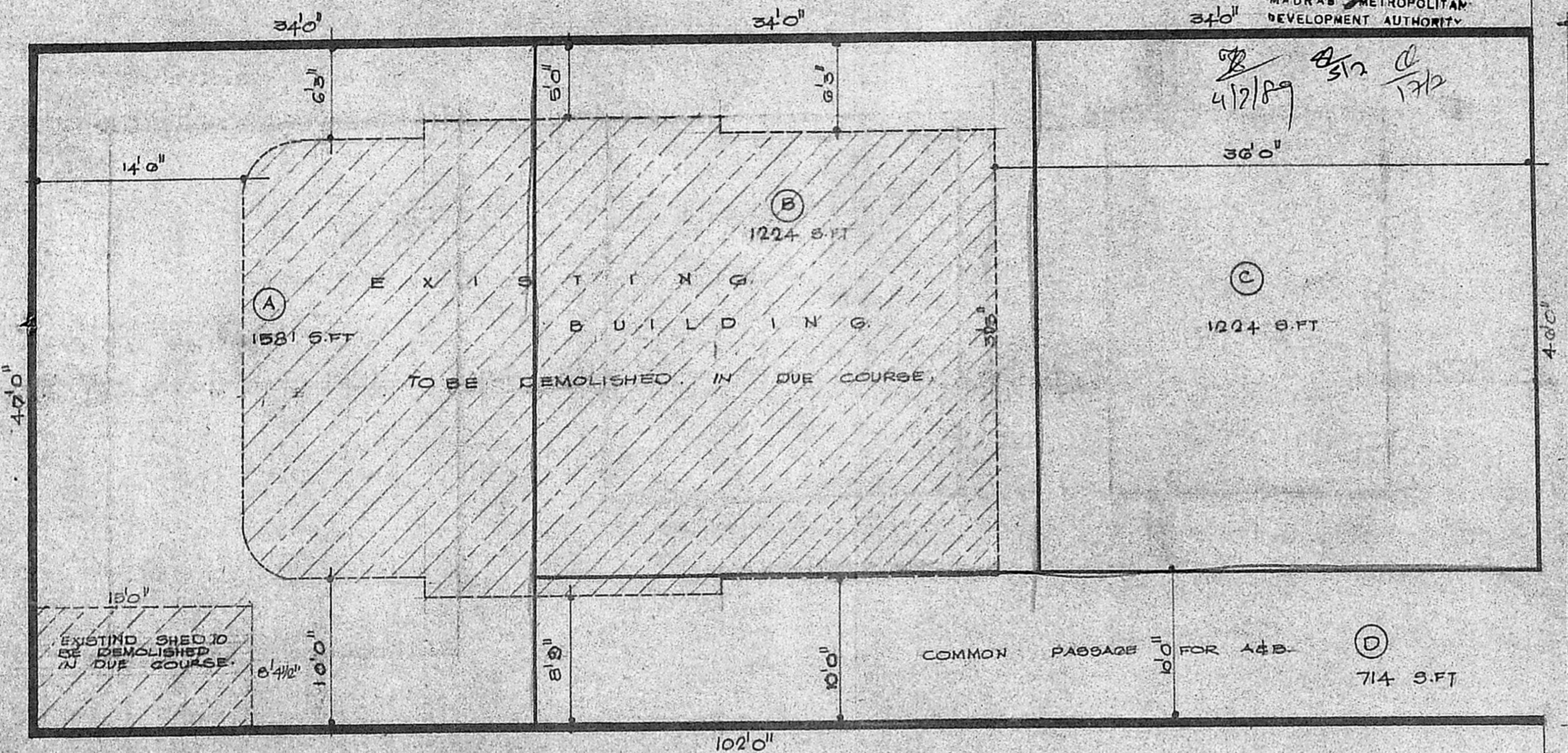

SITE PLAN
 SCALE: 1" = 8'0"

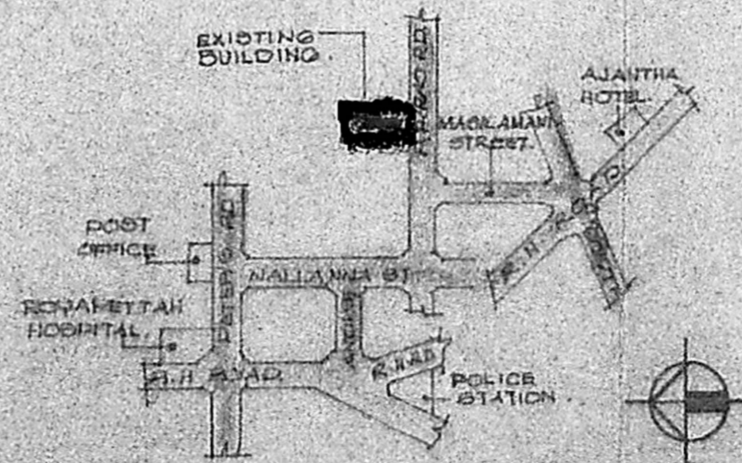

LOCATION PLAN
 (NOT TO SCALE)

AREAS	S.F.T	S.M
PLOT AREA	1743	440.60
BLOCK (A)	1581	146.93
BLOCK (B)	1224	113.75
BLOCK (C)	1224	113.75
PASSAGE (D)	714	66.36
EXISTING BUILDING TO BE DEMOLISHED IN DUE COURSE	1502	140.60
EXISTING SHED TO BE DEMOLISHED IN DUE COURSE	120	11.68

REFERENCE:

- EXISTING TO BE DEMOLISHED
- PROPOSED
- ROAD
- BOUNDARY

PROPOSED SUB-DIVISION AT
 NO 29 P.P. RAO ROAD MADRAS
 R.S. NO 652/9 DIVISION NO 103,
 BLOCK NR II, ROYAPETTAH.

SCALE 1"=80' DATE: N

Nalini Mahagan
 OWNER

LICENSED SURVEYOR.

Rajamathi Anand

ROOPMATHI ANAND, B.Arch.
 Architect C.A. 82/7641
 Licensed Surveyor No. RA. 94/85-87
 No. 29, P.P. RAO ROAD,
 MADRAS-600014

ARCHITECTS.

RAJENDRAN & ASSOCIATES,
 NO. 50-D L.B. ROAD,
 ADAYAR, MADRAS-20.